



"Our products make the difference."

Drop-in Sink

MT3322D-ADA

33"x22"x5-1/2"

Double Bowl Drop-in Kitchen Sink

This Drop-in stainless steel kitchen sink features a generous 5-1/2" depth basin, making it the right choice of handling large pots, pans, and dishes easily. This sink is made from 18-gauge stainless steel, and the bowl is a spacious 5-1/2" deep.

Product Features

- Handcrafted stainless steel kitchen sink
- Single basin design for maximum workspace
- High-quality 18-gauge thickness stainless steel for lasting durability
- Bowl gives you maximum space for washing dishes or other household tasks
- Drop-in installation
- Cutout template and instructions included



Technical

- **Nominal Dimensions:**
33"x22"x5-1/2"
838x559x140mm
- **Bowl Size:**
14"x16"
356x406mm

* Sink only. Waste fittings not included.

Quality Assurance

- Factory tested
- 10-year limited warranty

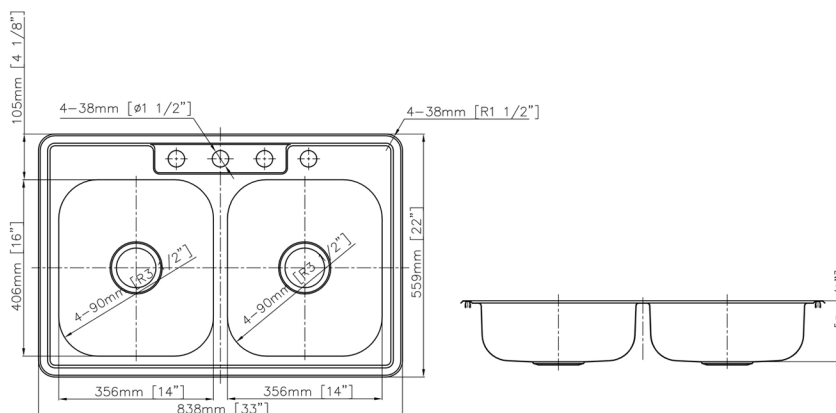

www.dukobrand.com



1411 E Orangethorpe Ave, Fullerton, CA 92831 Tel: 800-315-3776 Email: info@dukous.com