



"Our products make the difference."

Two-Piece Toilets

A249R+T49S

Two-Piece, Dual Flush, Round Front

A Classic Design with a Water Saving Flush System

Made from a durable vitreous china, the Laguna 1.28 round front toilet delivers that classic look of a two-piece toilet. With a water-saving 1.28 gallons per flush, the quiet and dependable flushing system gives homeowners peace of mind while conserving water.

Product Features

- 2" Fully glazed trapway - NO clogs, NO leaks
- Reliable and exclusive water fittings - bringing a quiet and powerful flush
- Siphonic, Two-piece
- Vitreous China
- cUPC & WaterSense certified

Technical

- Single flush 1.28gpf (4.8Lpf)
- S-trap, 12"/305mm rough-in
- 2"/51mm fully-glazed trapway
- 16-1/2"/420mm from seat bolt hole to front
- 15-1/8"/385mm height of the bowl
- 3"/76.2mm tank outlet
- Nominal Dimensions:
26-3/4" x 16-7/16" x 28-7/8"
680mm x 417mm x 734mm

Quality Assurance

- Factory flush-tested
- 10-year limited warranty

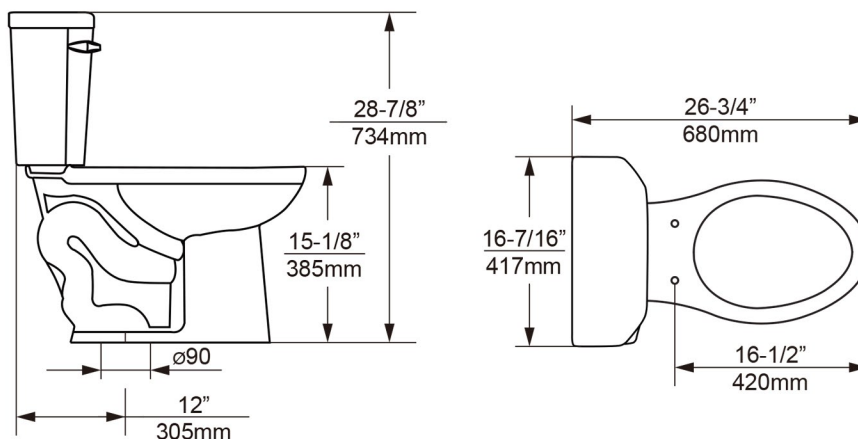

www.dukobrand.com



1411 E Orangethorpe Ave, Fullerton, CA 92831 Tel: 800-315-3776 Email: info@dukous.com