



*"Our products make the difference."*

## Two-Piece Toilets

### A249HL+T49S

ADA Height, Two-Piece, Single Flush, Elongated Toilet

#### A Classic Design with a Water Saving Flush System

Made from a durable vitreous china, the Seneca 1.28, an ADA compliant elongated toilet, delivers that classic look of a two-piece toilet. With a water-saving 1.28 gallons per flush, the quiet and dependable flushing system gives homeowners peace of mind while conserving water.

#### Product Features

- ADA compliant, vitreous china, elongated, two-piece toilet
- High performance bowl is designed for superior flushing power
- Computer designed, fully glazed trapway
- Anti-microbial, non-staining porcelain glaze
- cUPC & WaterSense certified

#### Technical

- Single flush 1.28gpf (4.8Lpf)
- S-trap, 12"/305mm rough-in
- Fully glazed, 2"/51mm trapway
- 3"/76.2mm tank outlet
- 18-1/2"/470mm from seat bolt hole to front
- 17-5/16"/440mm height of the bowl
- Nominal Dimensions:  
28-3/4" x 16-7/16" x 31-1/8"  
730mm x 417mm x 791mm



#### Quality Assurance

- Factory flush-tested
- 10-year limited warranty

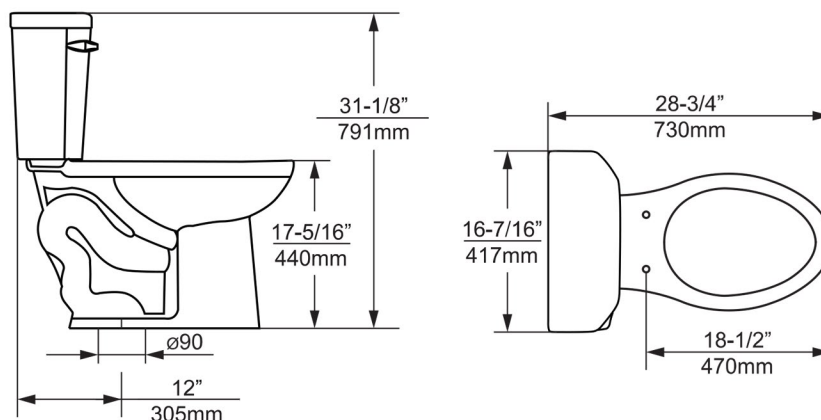

[www.dukobrand.com](http://www.dukobrand.com)



1411 E Orangethorpe Ave, Fullerton, CA 92831 Tel: 800-315-3776 Email: [info@dukous.com](mailto:info@dukous.com)